

# Changing East/West Gateway



- Launch Pulse Secure using the Start menu or Desktop Icon on your PC.

- Click the PROCEED Button



- Click the + Button



- Enter the Connection information



Name: CMS

Server URL: QIES-EAST.CMS.GOV OR QIES-WEST.CMS.GOV

- Click the ADD button

**NOTE:** Facilities WEST of the Mississippi River will use QIES-WEST  
Facilities EAST of the Mississippi River will use QIES-EAST  
This is strictly for load balancing. It will not affect your submission. If the West is down you can use the East and vice versa.

- Click the CONNECT button.

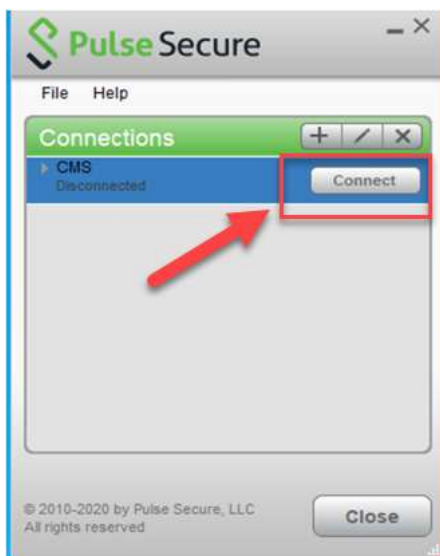

- Open a Supported Web Browser of choice (Microsoft Edge, Google Chrome, or Firefox). **(Internet Explorer 11 is no longer supported.)**,
- Then copy and paste the appropriate URL into your web browser (**do not click the links below**)

For MDS: [https://web.qiesnet.org/qiesmds/mds\\_home.html](https://web.qiesnet.org/qiesmds/mds_home.html)

For SWB: <https://web.qiesnet.org/qiessb/home.html>

For HOSPICE: <https://web.qiesnet.org/qieshospc/home.html>

- Save the site as a bookmark or shortcut if desired

If you are having issues, please contact the CMSNet Remote User Support helpdesk.

Phone: (888) 238-2122

E-Mail: [MDCN.MCO@PALMETTOGBA.COM](mailto:MDCN.MCO@PALMETTOGBA.COM)